

# Features

## 1/4", 3/8" & 1/2" Ports

ARO Module/Air 2000® oil-fog lubricator features an adjustment needle on top of the transparent sight dome. The adjustment needle features finer threads and improved tolerances between the needle and seat. Lubricator drip rate adjustment is easier to set. The required amount of lubrication can be efficiently delivered for longer life of tools, cylinders, valves, pumps, air motors and other air-operated equipment.

- Lubricator can be filled while under pressure. This avoids the inconvenience of system pressure shut-down and the resulting downtime.
- The oil adjustment screw has an optional tamper-resistant cap which helps prevent unauthorized adjustment of oil.
- INCREASE / DECREASE markings on castings show direction to turn adjustment screw for easy oil drip set-up.
- Warning and technical information is printed in English, Spanish, French and German on standard units.
- Bayonet bowl attachment provides easy removal.
- Units have threaded ports for direct connection to pipe plumbing or, when used with modular port adapter kits, a single unit or combination of units can be piped into the air system in a modular arrangement.

**NOTE:** See cautions on the use of polycarbonate bowls. (Page 78)



GRAPHIC SYMBOL



# Performance Specifications

### Models & Dimensions, in. (mm)

<b>Body:</b>	Zinc die-cast
<b>Bowls:</b>	Polycarbonate or Zinc die-cast
<b>Bowl Guard:</b>	Zinc die-cast
<b>Sight Glass:</b>	Polyimide-Nylon 12
<b>Seals:</b>	Buna N
<b>Sight Dome:</b>	Polycarbonate
<b>Oil Capacity:</b>	6 oz. (177 ml)
<b>Max. Inlet Pressure:</b>	Polycarbonate bowl — 150 PSIG (10.4 bar) Metal bowl — 175 PSIG (12 bar)
<b>Operating Temperature Range:</b>	Polycarbonate Bowl - 0° to 125° F (-18° to 52°C) Metal Bowl - 0° to 175° F (-18° to 79°C)
<b>*Flow:</b>	1/4"=75 scfm (35 dm <sup>3</sup> /s) 3/8" = 100 scfm (47 dm <sup>3</sup> /s) 1/2" = 110 scfm (52 dm <sup>3</sup> /s)

\*Air flow is at 90 PSIG (6.2 bar) inlet and 10 PSIG (0.7 bar) pressure drop.

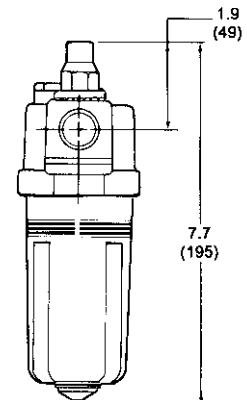
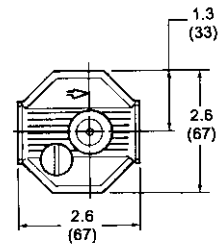

# Ordering

## 1/4", 3/8" & 1/2" Ports

PORT SIZE NPT	FLOW		MODEL	BOWL SIZE oz. (ml)	WEIGHT lbs. (kg)
	scfm	(dm <sup>3</sup> /s)			
1/4"	75	(35)	L26221-110	6.0 (177)	1.50 (.68)
3/8"	100	(47)	L26231-110	6.0 (177)	1.44 (.65)
1/2"	110	(52)	L26241-110	6.0 (177)	1.36 (.62)

### metal bowl with sight glass

### polycarb. bowl with bowl guard

1/4"	75	(35)	L26221-100	6.0 (177)	1.50 (.68)
3/8"	100	(47)	L26231-100	6.0 (177)	1.44 (.65)
1/2"	110	(52)	L26241-100	6.0 (177)	1.36 (.62)

From the chart at left, select the model number associated with port size and bowl option required. If other options are preferred, use menu below.



L26241-100

## Additional Models Available

Select the basic model number associated with the port size desired. From the table below, select the numbers representing the lubricator options required. For BSP threads, add -B to end of model number.

Port Size Basic Model

1/4" L26221 - X X X

3/8" L26231 - X X X

1/2" L26241 - X X X

Shaded area = Best-Selling Models

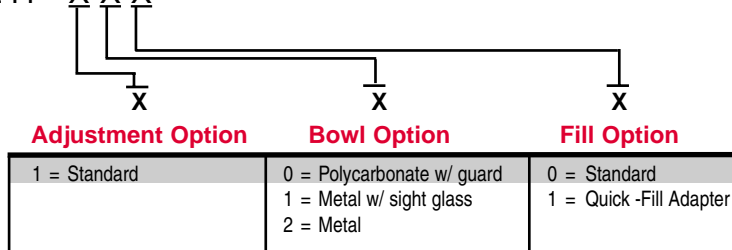

# Accessories

## Lubricator

MODEL	DESCRIPTION
104027	Tamper-Resistant Plug
104107	Mounting Bracket
104181	Service Kit
104182	Sight Glass Service Kit
104203	Polycarbonate Bowl w/ guard
104205	Metal Bowl w/ sight glass
104207	Metal Bowl
104211	Metal Bowl w/ sight glass and Quick-Fill Adapter
104226	Sight Dome Service Kit
29235	Quick-Fill Adapter
29665	Lubricating Oil (1 qt.) For additional details, see page 71.



29665



104211