

Features

1/2", 3/4" & 1" Ports

These ARO Heavy-Duty Series filters extend the life of air-operated equipment while reducing maintenance costs. These units efficiently remove solid particles from compressed air lines – making them the perfect choice for large flow applications.

- The baffle and filter assembly is completely encased, leaving the entire bowl for sump.
- Polycarbonate bowl and metal guard standard.
- Tie-rod filter assembly permits quick, easy service.
- Twist drain is brass construction with large passage area for draining.
- Optional automatic drain has 1/8" pipe outlet for draining away contaminant's.

Performance Specifications

Sump Capacity:	10 oz. (295 ml)	Body:	Zinc Die Cast
Filter Area:	9.1 in. (5871 mm)	Bowls:	Polycarbonate or Steel
Max. Inlet Pressure:	Polycarbonate Bowl - 200 PSIG (13.8 bar)	Bowl Guards:	Steel With E-Coat Finish
	Metal Bowl - 250 PSIG (17 bar)	Seals:	Buna-N
Oper. Temp. Range:	Polycarbonate bowl - 0° to 125° F (-18° to 52° C)	Drain:	Brass Twist Type
	Metal Bowl - 0° to 200° F (-18° to 93° C)	Element:	Sintered Bronze
			5, 20, 40 Micron
Weight:	1/2" = 3.62 lbs. (1.65 kg), 3/4" = 3.48 lbs. (1.58 kg) 1" = 3.26 lbs. (1.48 kg)		
*Flow:	1/2" = 82 SCFM (39 dm³/s), 3/4" = 87 SCFM (41 dm³/s) 1" = 88 SCFM (42 dm³/s)		

*Air flow is at 125 PSIG (8.6 bar) and 100 PSIG (6.9 bar) outlet.



25361-020

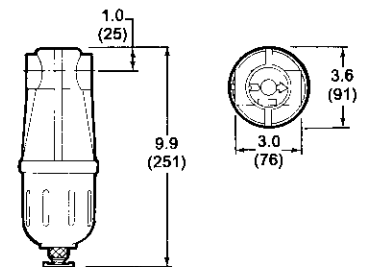
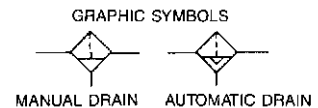

Ordering

Select basic model representing the port size desired. Add number representing filter options required.

PORT SIZE BASIC MODEL

1/2"	25341-	X	X	X
3/4"	25351-	X	X	X
1"	25361-	X	X	X

	Shaded area = Best-Selling Models			
		Filter Element	Bowl Option	Drain Option
		0 = 40 micron #29392	2 = Polycarbonate w/ guard #29397	0 = Manual
		1 = 20 micron #29391	1 = Metal Bowl #29967	1 = Auto Drain #29969-2
		2 = 5 micron #29390		

Accessories

Filter

MODEL	DESCRIPTION	MODEL	DESCRIPTION	MODEL	DESCRIPTION
29397	Bowl Guard	29390	5 Micron Element	104020	Service Kit
29967	Metal Bowl	29391	20 Micron Element	104069	Polycarbonate Bowl
29969-2	Automatic Drain	29392	40 Micron Element	Y57-1	Twist Drain



29397 29967 29969-2